

THE INFORMATION CONTAINED IN THIS DRAWING IS THE SOLE PROPERTY OF BARROUR STOCKWELL, INC. ANY REPRODUCTION IN PART OR WHOLE WITHOUT THE WRITTEN PERMISSION OF BARROUR STOCKWELL, INC. IS PROHIBITED.

REVISIONS		DATE	APPROVED
SCOPE	REV.	DESCRIPTION	
	01		8/11/2011
	-		2/17/2012

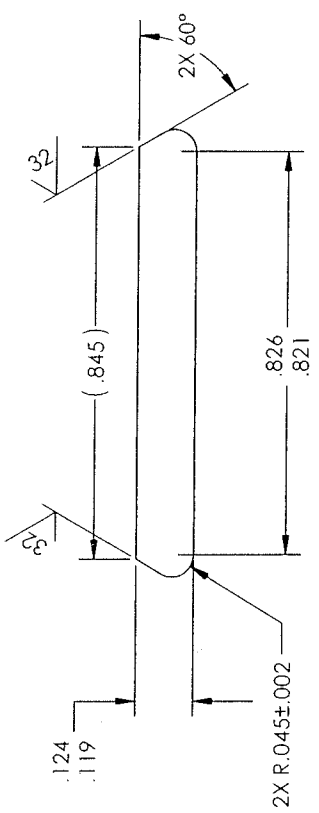
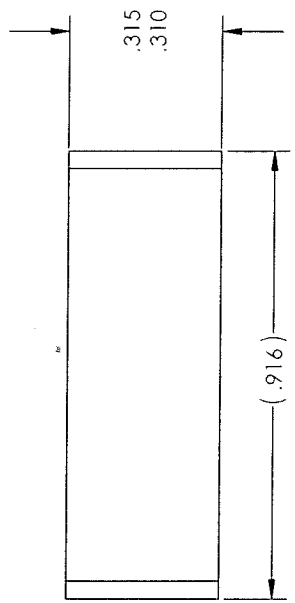
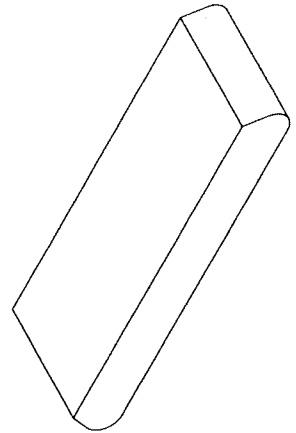

Material	RPM	Max Speed
Ti 6/4 (annealed)	14500	m/s 366
17-4 PH H1150 condition	14500	366
15-5 PH H1150 condition	14500	366
Stellite 6	14500	366
In 718	14500	366

 BARROUR STOCKWELL INCORPORATED	CAD GENERATED DRAWING DID NOT MANUALLY UPDATE	APPROVALS DATE 8-9-11
	UNLESS OTHERWISE SPECIFIED DIMENSIONS ARE IN INCHES TOLERANCES ARE: DECIMALS .015 FRACTIONS 1/32 ANGLES .005 HOLE POSITION .005	CHECKED KM 2-17-12
MFG PART PRODUCTION 	MATERIAL FINISH HARDNESS	SEE TABLE 125 RMS NONE
FLAT SAMPLE		REV. 12295-02 12295-02 - Flat Sample

- NOTES:
- BREAK ALL SHARP EDGES R0.02 MAX.
 - MAX CORNER RADIUS 0.01 UNLESS OTHERWISE NOTED
 - DEBURR ALL DRILLED AND TAPPED HOLES Ø 1/32 OVERSIZE
 - ALL DIAMETERS TO BE CONCENTRIC WITHIN 0.005.

8 7 6 5 4 3 2 1

F E D C B A

1 2 3 4 5 6 7 8

Sheet of 1